

# Flushline Mark 2 Panel

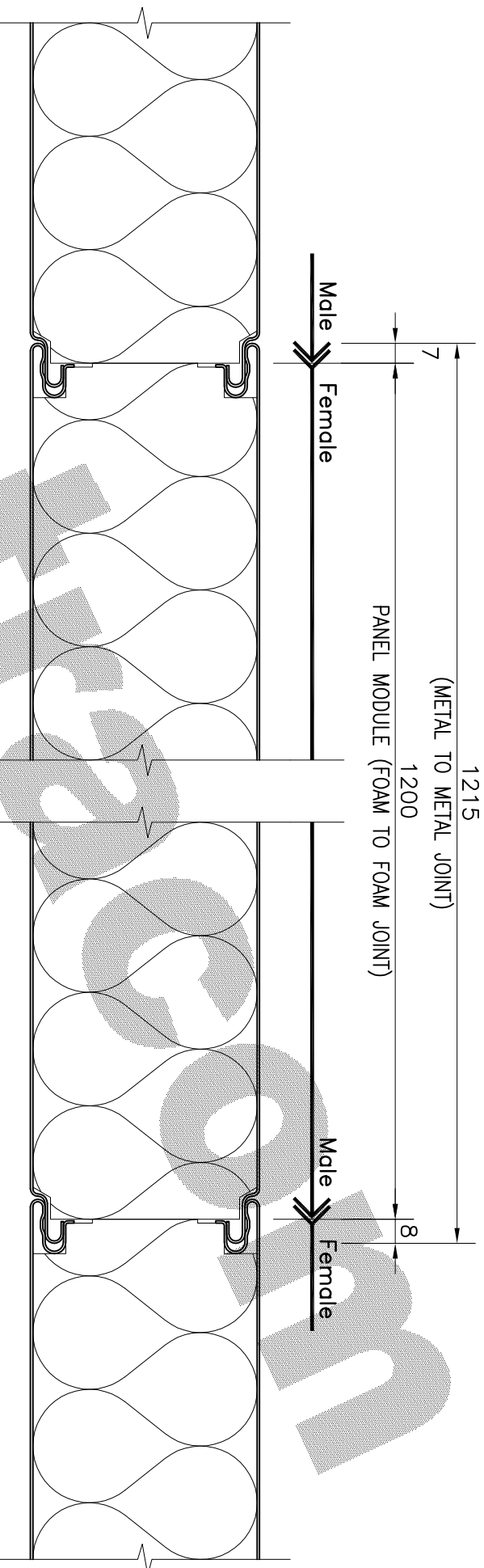

## PANEL DATA

**LENGTH:** SUPPLIED TO SUIT APPLICATION. (MIN. 1800mm L.)  
LIMITED BY HANDLING, TRANSPORT & DESIGN CONSIDERATIONS.

**WIDTH:** MODULE: 1200mm STANDARD.  
ACTUAL PANEL WIDTH: 1215mm.

**STEEL FACINGS:** 0.4 & 0.6 CRP GRADE ORE PAINTED GALVANISED STEEL,  
OFF WHITE 25% GLOSS AS STANDARD.

**PANEL CORE:** CLOSED CELL FIRE RETARDANT EXPANDED  
POLYSTYRENE (EPS), CLASS SL STANDARD.

## PROPERTIES TABLE

	50	75	100	150	200	250
THICKNESS (mm)	50	75	100	150	200	250
Mass kg/m <sup>2</sup> (0.4 STEEL)	8.1	8.5	8.9	9.7	10.5	11.3
Mass kg/m <sup>2</sup> (0.6 STEEL)	11.3	11.7	12.1	12.8	13.6	14.4
Thermal Properties (at 6°C)						
'U' Value (W/m <sup>2</sup> K)	.76	.51	.38	.25	.19	.15
Coldroom 'R' Values (m <sup>2</sup> K/W)	1.32	1.97	2.63	3.95	5.26	6.58
Built up Systems:						
Walls	1.5	2.2	2.8	4.2	5.5	6.8
Ceilings	1.5	2.2	2.8	4.1	5.5	6.8

\* NOTE: \* DIMENSIONS ARE IN "mm." \* DO NOT SCALE



60 Magnessium Drive  
Crestmead, QLD. 4132  
Telephone: (07) 3803 4733  
Facsimile: (07) 3803 4711  
Email: sales@retracom.com.au

THIS DRAWING IS THE PROPERTY OF RETRACOM,  
AND IS RESTRICTED TO ITS OWN USE. THE WHOLE  
OR ANY PART THEREOF MAY NOT BE COPIED OR  
REPRODUCED OR LOANED IN ANY FORM WITHOUT  
THE WRITTEN AUTHORISATION OF THE COMPANY.

Title: **FLUSHLINE MARK 2 PLAIN PANEL JOINT**  
**SECTIONAL VIEW**

For: **COLDROOMS & FREEZER ROOMS**

Date Drawn: SEP 2007 By: T.S./I.B. Job No: ...  
Checked: ... Drawn: ...  
Scale: N.T.S. Sheet: A4 of 1  
Revised: ...  
SPA-01-005-01  
FEB 2010